

MHT[®] 轻型渣浆泵 LIGHT-DUTY SLURRY PUMP

- 冶金 Metallurgy
- 电厂脱硫 Desulfurization plant
- 膨润土 Bentonite
- 化工 Chemical
- 环保 Environmental protection

- 按需要选择抗磨、耐腐泵材料
Abrasion-resistant and corrosion-proof material
- 符合 ISO2858、ISO5199
Conform to ISO2858; ISO5199
- 最大工作压力 1.6MPa
Max working pressure 1.6MPa
- 流量 (2~1000)立方米/小时
Capacity (2~1000)m³/h
- 扬程 (8~100)米
Total head (8~100)m
- 温度 (-20~180)°C
Temperature (-20~180)°C
- 1995年通过ISO9001质量管理体系认证
Attained the ISO9001 quality management system authentication in 1995
- 2005年通过ISO10012:2003国际测量管理体系认证
Attained the ISO10012:2003 measurement management system authentication in 2005
- 2006年通过AAA级企业标准体系认证
Attained the AAA standardization system authentication in 2006
- 2011年通过ANSI/API Spec. Q1, ISO/TS29001质量管理体系认证
Attained ANSI/API Spec. Q1, ISO/TS29001 quality management system authentication in 2011

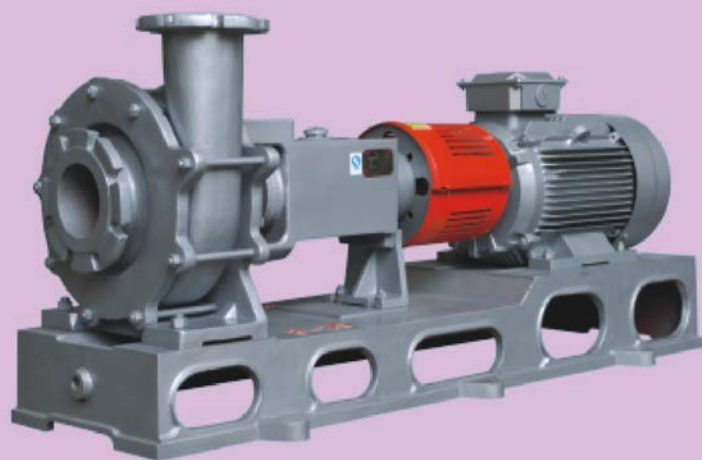

省级
化工泵
研发中心



浙江省劳动保障
优秀企业

ISO9001
质量管理
体系认证



Q1-1125



杭州碱泵有限公司
HANGZHOU ALKALI PUMP CO.,LTD.

华原新科技



目 录

CONTENTS

一、MHT轻型渣浆泵简介	
INTRODUCTION TO MHT LIGHT-DUTY SLURRY PUMP·····	(1)
二、泵的结构	
STRUCTURE·····	(2)
三、泵的密封	
PUMP SEAL·····	(3)
四、泵的驱动方式与联轴器	
DRIVING AND COUPLING·····	(5)
五、安装和操作指导	
INSTALLATION AND OPERATION INSTRUCTION·····	(6)
六、订货须知	
NOTICE TO ORDER·····	(7)
七、技术参数	
PERFORMANCE TABLE OF MHT SERIES PUMP·····	(8)

使用 前 请 详 细 阅 读
READ CAREFULLY BEFORE USING

泵工作条件 Working Conditions of the Pump									
工作条件 Operating conditions					输送介质 Pumped fluid				
流量 Capacity	m ³ /h	最大 Max	额定 Rated	最小 Min	1介质 1Media	最大比例 Max ratio	%	最小比例 Min ratio	%
扬程 Total head	m	最大 Max	额定 Rated	最小 Min	2介质 2Media	最大比例 Max ratio	%	最小比例 Min ratio	%
进口压力 Suction pressure	MPa	最大 Max	额定 Rated	最小 Min	3介质 3Media	最大比例 Max ratio	%	最小比例 Min ratio	%
出口压力 discharge pressure	MPa	最大 Max	额定 Rated	最小 Min	固 体 Solid	含量(湿基) Content (humidity) Wt %			
必需汽蚀余量 NPSH required	m					粒度直径 Particle diameter mm			
操作条件 Operating conditions	连续 Continuous		间断 Intermittent		介质特性 Medium characteristics	腐蚀 Corrosion	磨(冲)蚀 Abrasion		
现场资料和公用事业条件 Spot conditions					泵送温度 Operation temp	℃	最大 Max	正常 Normal	最小 Min
位置 Position					密度 Density	在操作温度下 Under operating temp kg/m ³			
室内 Indoor	有采暖 With heating		有遮棚 With shield		粘 度 Viscosity	在操作温度下 Under operating temp mPa.s			
室外 Outdoor	无采暖 Without heating		无遮棚 Without shield		汽化压力 Vapor pressure	在操作温度下 Under operating temp MPa(A)			
必须的防寒气候条件 Requirement of Cold-proof					比 热 Specific heat	kcal/kg℃			
必须的耐湿热气候条件 Requirement of Damp-heat-proof					氯化物浓度 Concentration of chloride	PPM			
现场资料 Site condition					H2S(硫化氢)浓度 Concentration of H2S	PPM			
海拔高度 Altitude	m				危险程度 Hazardous liquid	易燃 Flammable	易爆 Explosive	有毒 Toxic	
大气压力 Atmosphere pressure	kPa				挥发特性 Volatile characteristics	易 Easy	不易 Not easy		
相对湿度 Relative humidity	最大 Max	最小 Min	%		沸 点 Boiling point	℃			
环境温度范围 Ambient temp. Range	℃				结晶温度 Crystallization temp	℃			
异常条件 Abnormal conditions	粉尘 Dust	烟雾 Smoking			熔 点 Smelting point	℃			
危险区域 Electrical classification	类 Class	级 Division	组 Group		闪 点 Point of flammability	℃			
电源 Power source	伏特 Volt	赫兹 Hz	相 Phase		相溶的液体 Compatible liquid				
冷却水 Cooling water	温度 Temp	℃	压力 Pressure	MPa	相溶的橡胶 Compatible rubber				
	氯化物浓度 Chloride concentration			PPM	临界温度 Critical temp	℃			
仪表压缩空气 Compressed air of instrument	最大/最小压力 Max / Min. Pressure			/MPa	临界压力 Critical pressure	MPa			
传动方式 Driving way					其 它 Other				
联轴器 Coupling type									

一、MHT轻型渣浆泵简介 INTRODUCTION TO MHT LIGHT-DUTY SLURRY PUMP

(一) 简介

MHT轻型渣浆泵是本公司为膨润土行业，磨料磨具行业，电厂脱硫和铝厂铝土矿浆料输送而开发的专用设备，是和压滤机配套较理想的输送设备，也是含有硬杂物介质的最佳输送设备。它具有：操作简单、耐腐蚀、运行经济和密封可靠等优点。适用于膨润土、石灰乳、煤灰、石膏浆料、含砂原油的输送。

1. INTRODUCTION

MHT light-duty slurry pump is designed for bentonite industry, abrasive and grinding tools manufacture, desulfation of power plant and conveyance of alumina ore slurry in aluminum plant, and is the ideal device matched with filter press and the optimal choice for conveying medium containing hard sundries. MHT is simple in maintenance, highly resistant against abrasion and corrosion, economical in operation and reliable in sealing. It is suitable for conveyance of bentonite, lime milk, coal ash, gypsum slurry and sand-bearing crude oil.

(二) 用途

碱和无机盐：石灰乳、盐泥。

有色金属冶炼：生产铝、铜、钒、锌的矿浆液。

石油化工：含砂原油。

造纸工业：石灰乳

发酵工业：各种发酵浆液。

电厂环境保护：煤灰、石膏浆料。

2. Application

Soda and inorganic salts: lime milk, and salt mud.

Metallurgy: ore slurry for zinc, aluminium, copper, vanadium production.

Petrochemical industry: sand-bearing crude oil.

Paper-making industry: lime milk.

Fermentation industry: various fermenting liquid.

Environmental protection in power plant: coal ash, gypsum slurry.

(三) 材料

与介质接触的过流部件，常用材料如下：

MCU、Cr15Mo3、DTM、M-3。

3. Materials

For wetted parts in contact with medium, the common materials are as follows:

MCU, Cr15Mo3, DTM, M-3.

(四) 泵型号举例说明 Pump model illustration

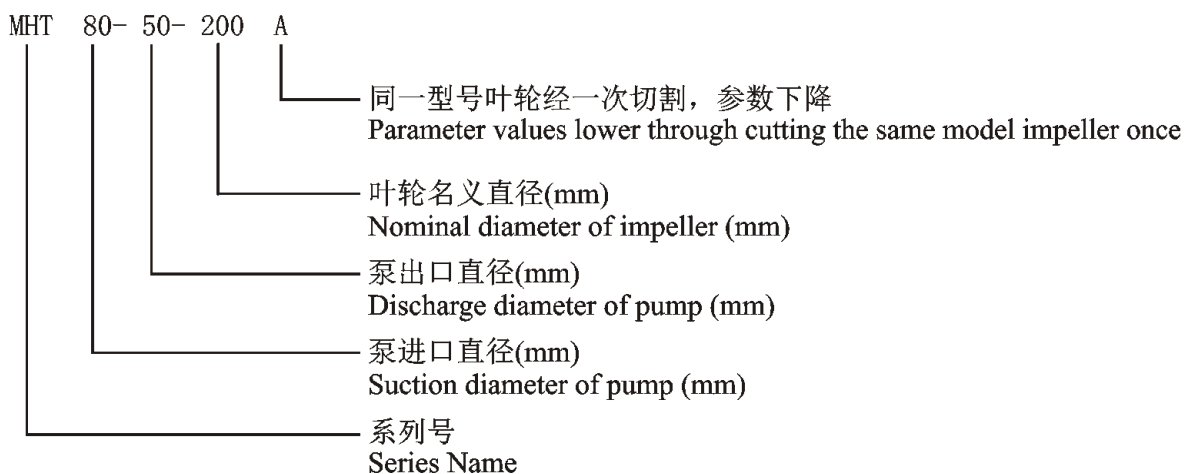

二、泵的结构 STRUCTURE

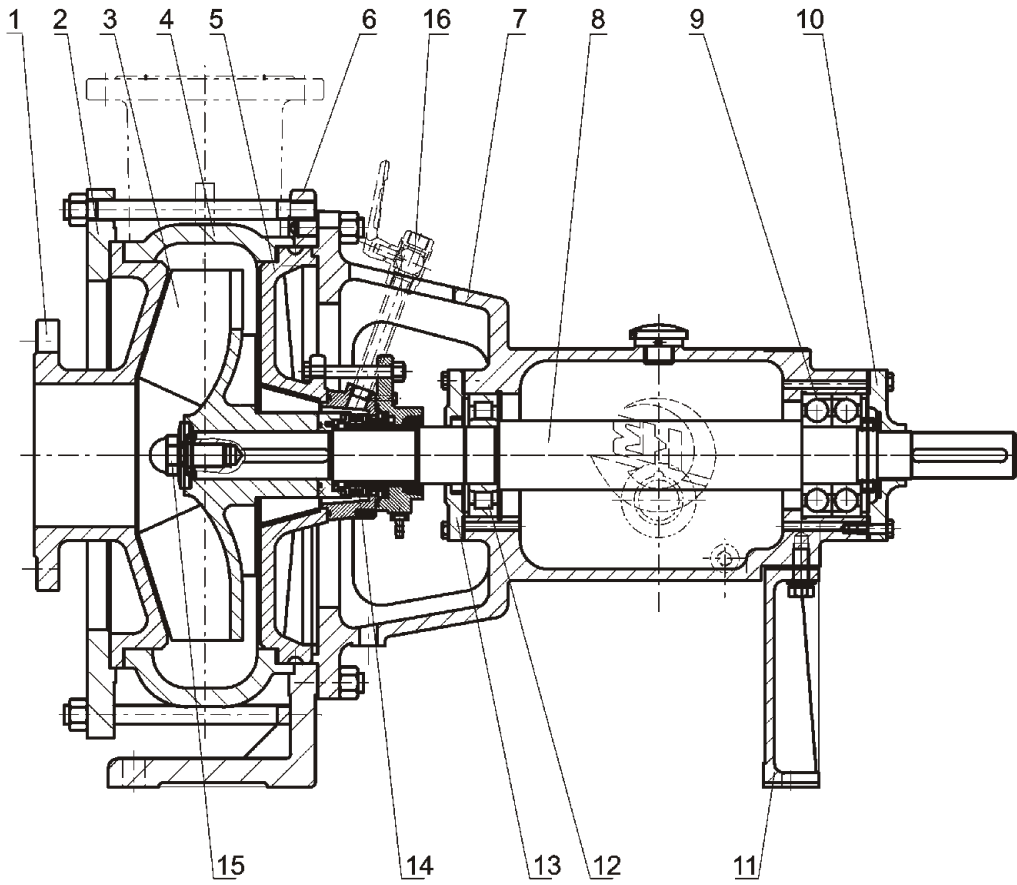

- 1. Front cover
- 2. Pressure plate of front cover
- 3. Impeller
- 4. Pump casing
- 5. Pump cover
- 6. Pressure plate of pump cover
- 7. Frame
- 8. Shaft
- 9. Back bearing
- 10. Back cover of bearing
- 11. Frame feet
- 12. Front bearing
- 13. Front cover of bearing
- 14. Mechanical seal
- 15. Impeller nut
- 16. Flush inlet

- | | | | |
|--------|--------|---------|------------|
| 1、前盖板 | 5、泵盖 | 9、后轴承 | 13、轴承前盖 |
| 2、前盖压板 | 6、泵盖压板 | 10、轴承后盖 | 14、机封 |
| 3、叶轮 | 7、悬架体 | 11、支架 | 15、叶轮螺母 |
| 4、泵体 | 8、轴 | 12、前轴承 | 16、密封冲洗液进口 |

泵的旋转方向：

从驱动端看，按顺时针方向旋转。

Rotation direction of pump:

It is clockwise viewed from the driver end.

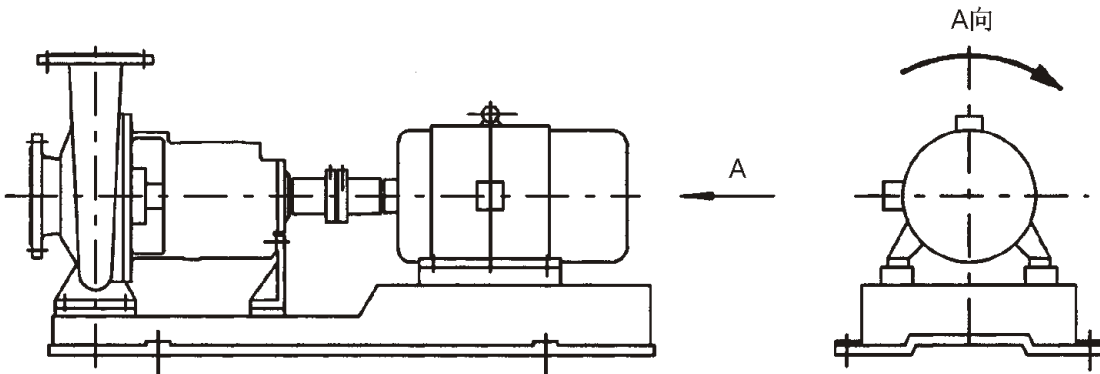

泵的结构特点:

泵体为轴向吸入、径向排出。泵盖通过止口固定在悬架体上，泵体和悬架体将泵盖夹紧。在检修时拆除悬架体与泵体之间的联接螺母，泵的传动部分便可从泵体中退出，无需拆卸进出口管路。对于大规格泵，泵联轴器和电机轴之间有一中间加长节，在检修时电机不必移动，拆下中间加长节，传动部分即可退出泵体，这是国际上通用的化工泵结构。

Characteristics of pump structure:

The pump is a centrifugal pump of horizontal, axial end

suction and radial discharge design. The pump cover is fixed on the frame and is clamped tightly by pump casing and frame. When maintenance, disassemble the connecting nut between the frame and the pump casing, the pump's driving part can be pulled out of pump casing without disassembling the pipeline of suction and discharge. For large pumps, there is a connector between pump coupling and the motor shaft. When maintenance, don't remove the motor, just remove the connector, the driving part can be pulled out of the pump casing. This is a universal structure of chemical process pump used internationally.

三、泵的密封 PUMP SEAL

(一) 171S机械密封说明

171S机械密封是一种先进的轴封结构，具有泄漏量小、功耗低、寿命长等优点。是我公司从制碱制盐工艺介质情况出发，专门设计的一种单端面、内装式、多弹簧、平衡型机械密封。该机械密封的摩擦副组对优先采用硬质合金，配合锥形密封腔设计非常适合介质中含少量颗粒、结晶的情况。该机械密封是本公司的专利产品，专利号ZL92 2 20977.4。

密封的最佳冲洗方案为API682的(32+62)，即外加冲洗液和急冷液，冲洗液的目的是冲洗密封腔内渣浆的积聚，当冲洗液常开时，压力应大于密封腔内压力(0.05~0.1)MPa，也可以间断冲洗，在停机和开机前冲洗密封腔。急冷液的目的是冲洗掉因机封泄漏在大气侧的积聚物，以保证机封静环的追随性和弹簧的压力。

1. Instructions for 171S mechanical seal

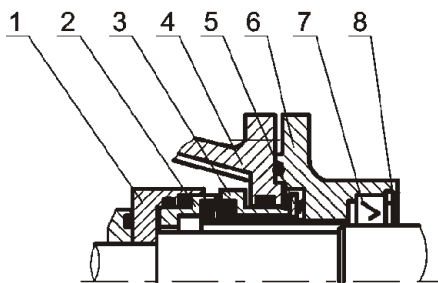

(171S型机械密封示意图)

(Figure of 171S mechanical seal)

171S mechanical seal is an advanced shaft-sealing structure and possesses the advantages of few leakage, low power consumption and long service life. It is of single, internal, multi-springs and balanced seal design according to the medium of soda and salt-making process. With hard alloy faces, 304 stainless steel springs, fluoroelastomer "O" ring, 316 metal components and tapered seal chamber, the mechanical seal is very suitable for media containing small amount of particles and crystal. The mechanical seal is the patent product of HANGZHOU ALKALI PUMP company, with the patent No.ZL92 2 20977.4.

The optimal flushing scheme of seal is API682 (32+62), that is flushing with external flushing liquid and quick cooling liquid. The purpose of flushing liquid is to flush the accumulated slurry in the sealing chamber, when being opened, its pressure should be (0.05-0.1) MPa higher than that in sealing chamber. Discontinuous flush also can be used before shutting down and starting. The purpose of quick cooling liquid is to flush matters caused by leakage of mechanical seal, to make sure the spring's pressure.

- | | |
|--------|-----------------------|
| 1、传动座 | 1. Driving seat |
| 2、动环 | 2. Dynamic ring |
| 3、静环 | 3. Static ring |
| 4、泵盖 | 4. Pump cover |
| 5、推环 | 5. Thrust ring |
| 6、静环压盖 | 6. Seal end gland |
| 7、骨架油封 | 7. Skeleton oil seal |
| 8、轴用挡圈 | 8. Circlips for shaft |

(二)、271C机械密封说明

271C机械密封是一种集装式机械密封，其安装、更换更为方便。其是一种单端面、内装式、平衡型机械密封。相比171S多了轴套结构，将轴与输送介质完全隔离开，防止所输送介质对轴的腐蚀。

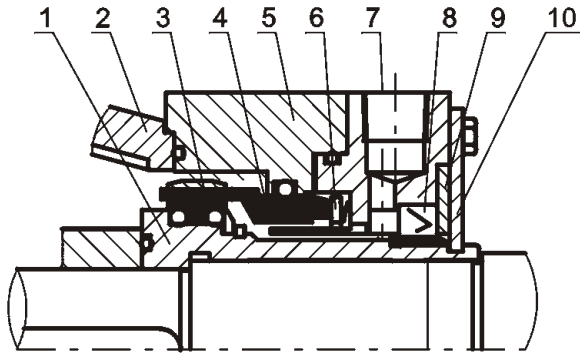

(271C型机械密封示意图)
(Figure of 271C mechanical seal)

2. Instructions for the 271C mechanical seal

271C mechanical seal is a container type mechanical seal, it's more convenient for installation and replacement. It's a single, internal and balanced mechanical seal. It has a axle sleeve compare with 171S, the shaft and the transmission medium is completely isolated to protect the shaft from corrosion.

- | | | | |
|------|---------|-----------------|----------------------|
| 1、轴套 | 6、推环 | 1. Axle sleeve | 6. Thrust ring |
| 2、泵盖 | 7、静环压盖 | 2. Pump cover | 7. Seal end gland |
| 3、动环 | 8、骨架油封 | 3. Dynamic ring | 8. Skeleton oil seal |
| 4、静环 | 9、油封挡板 | 4. Static ring | 9. Oil seal plate |
| 5、压盖 | 10、偏心挡板 | 5. Gland | 10. Eccentric plate |

(三)、动力密封说明

动力密封的工作原理

利用背叶片或副叶轮带动密封腔内的流体高速旋转并产生离心力，此力与工作叶轮产生的压力方向相反，以至减小或完全消除导致泄漏的压差。

动力密封使用说明

因为动力密封需靠叶轮背叶片或副叶轮旋转来达到密封，开车时填料不起作用，所以在设备停车时应应对填料压盖进行调整，达到无泄漏，开动设备前先将填料压盖放松，后启动设备，以防填料烧损，当进口压力超过 0.15MPa 时此种密封的效果不甚理想，建议采用机械密封。

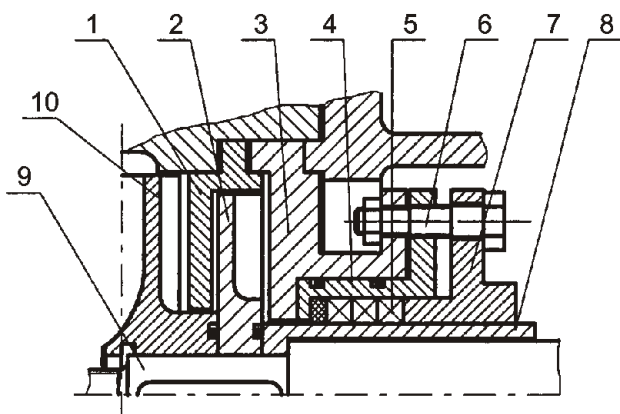

(动力密封示意图)
(Figure of dynamic seal)

3. Dynamic seal instruction

Working principle of dynamic seal

The fluid in the sealing chamber is driven by the back paddles and secondary impeller to rotate at a high speed, then generates centrifugal force which is contrary to the pressure generated by the main impeller so that the pressure difference which leads to leakage is decreased or fully eliminated.

Dynamic seal instruction

As dynamic seal acts by rotation of back paddles and secondary impeller, when operating, packing has no action. When pump stops, the packing gland should be adjusted to reach no leakage. Before operation, first loose the packing gland, and then start the pump to protect packing from burnout. When suction pressure surpasses 0.15MPa, the effect of dynamic seal is not ideal, it is recommended to adopt mechanical seal.

- | | |
|--------|-----------------------|
| 1、隔板 | 1. Spacer |
| 2、副叶轮 | 2. Secondary impeller |
| 3、泵盖 | 3. Cover |
| 4、填料套 | 4. Packing sleeve |
| 5、填料 | 5. Packing |
| 6、螺栓 | 6. Bolt |
| 7、填料压盖 | 7. Packing gland |
| 8、轴套 | 8. Shaft sleeve |
| 9、轴 | 9. Shaft |
| 10、叶轮 | 10. Impeller |

四、泵的驱动方式与联轴器 DRIVING AND COUPLING

MHT泵的驱动方式为联轴器直联, 驱动机为电机, 本公司不推荐皮带传动和其它传动方式。可用的联轴器种类见图:

(一) 爪形弹性联轴器

爪式弹性联轴器为传统的泵用联轴器, 它经济实惠, 简单实用, 但适用扭矩较小, 梅花弹性块易损。它主要适用于对补偿性能、缓冲减振要求不十分苛求的中小功率的传动轴系。

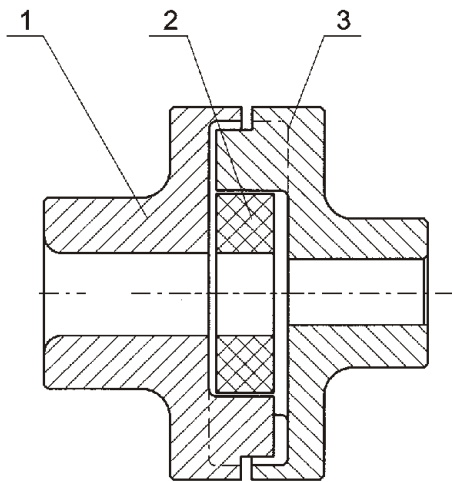

The driving way of the IJ series pumps is direct connection, and the driver is electric motor. Our company does not recommend the triangle belt drivers and other transmission ways. For various applications, there are three kinds of couplings for choice.

1. claw elastic coupling

The claw elastic coupling is a traditional pump coupling, it is economical and simple, but only suitable for transmission of small torque, and the quincunx elastic block is quick-wear part. It is mainly suitable for small and middle power transmission, which have not very strict requirements for compensation and vibration damping.

- | | |
|-------|----------------|
| 1、泵联 | Pump coupling |
| 2、弹性块 | Elastic block |
| 3、电联 | Motor coupling |

(二) 弹性套柱销联轴器

弹性套柱销式联轴器的特点是结构简单, 更换方便, 且具有一定的补偿性能和减震性能。

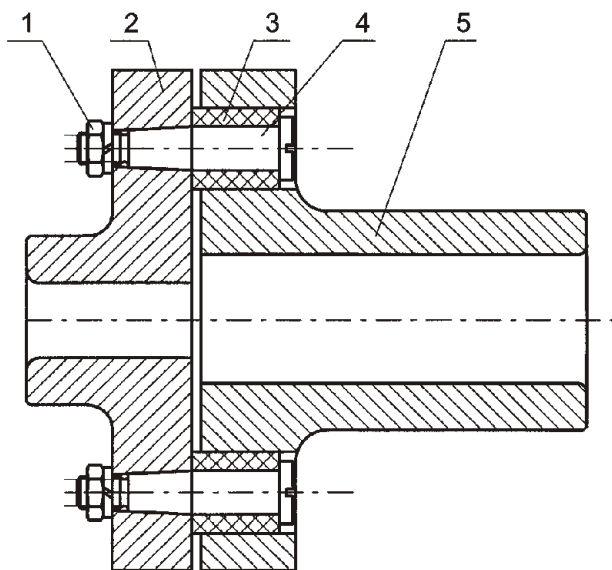

2. Elastic sleeve pin coupling

The characteristics of elastic sleeve pin coupling are simple structure, convenient replacement and having certain effect of compensation and vibration damping.

- | | |
|-------|-------------------|
| 1、螺母 | 1. Nut |
| 2、泵联 | 2. Pump coupling |
| 3、弹性套 | 3. Elastic sleeve |
| 4、柱销 | 4. Pin |
| 5、电联 | 5. Motor coupling |

(三) 金属膜片弹性联轴器

膜片式联轴器属金属弹性元件联轴器，属挠叠式联轴器的一种。它依靠金属膜片连接主、从动机传递扭矩，具有传递扭矩大、适用范围较宽、弹性减振、无噪声、不需润滑的优点。

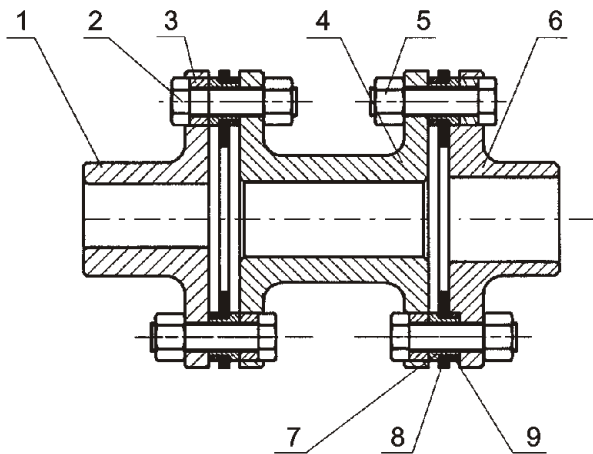

3. Metal slice coupling

Metal slice coupling belongs to the couplings with elastic metal component and is a kind of flexible coupling. It transmits the torque through the connection between the metal slice and the main, subordinate mechanism, and possesses the advantages of large torque transmission, wide applicable scope, vibration damping, no noise and no lubrication.

- | | |
|-----------|--------------------------------|
| 1、泵联 | 1. Pump coupling |
| 2、螺栓 | 2. Bolt |
| 3、压套 | 3. Press sleeve |
| 4、中间加长节 | 4. Intermediate connector |
| 5、螺母 | 5. Nut |
| 6、电联 | 6. Motor coupling |
| 7、电联膜片压紧套 | 7. Press sleeve for slice |
| 8、膜片 | 8. Metal slice |
| 9、膜片压紧块 | 9. Press block for metal slice |

五、安装和操作指导 INSTALLATION AND OPERATION INSTRUCTION

(一)、安装使用前，请仔细阅读《安装、使用、维护手册》。

(二)、管道重量必须另外支撑，泵不得承受管道的重量和其他扭力。

(三)、46#机械润滑油油量应控制在油窗两油位线之间。至少每3个月或运转2000小时，需要更换润滑油。

(四)、对新安装的管路和储罐应冲洗干净，防止有固体物质进入机械密封影响密封效果和寿命。开车前用手盘动联轴器，如在安装过程中产生卡死现象和碰撞异常情况应先排除。

(五)、冷却冲洗液应是干净的不结垢的软水。易结垢的水质会堵塞冷却冲洗液通路，影响密封的使用效果和寿命。用冷凝水作密封冲洗液效果是理想的，温度应 $<75^{\circ}\text{C}$ 。冷却冲洗液的压力 $\leq 0.1\text{MPa}$ ，流量为 $0.63\text{m}^3/\text{h}$ ，流量过小会影响密封的使用寿命。

(六)、启动前先接通冷却冲洗液，停车时应先停车再关闭冷却冲洗液。

(七)、开机前注意泵的旋转方向，勿开倒车。关机

1. Study Installation, Operation and Maintenance manual prior to the procedure of installation and operation.

2. The pipe must be supported independently to prevent the pump from bearing any strain and the weight of the pipeline.

3. Oil level of 46# lubrication oil should be controlled between the two oil levels of the oil sight window, the lubrication oil should be changed every 3 month or every 2000 hours of operation.

4. Pipeline and tank installed newly should be flushed to prevent solid matters from entering mechanical seal, affecting the seal effect and life. Before startup, turn the coupling by hand, if the phenomena of friction and bump happen, try to eliminate them firstly.

5. The cooling liquid should be clean and non-scaling water, the liquid being liable to generate scale shall block flushing pipeline, affecting the effect and life of seal service. The condensed water is the ideal one as a flushing liquid for seal, and the temperature should be less than 75°C . The pressure of the cooling flushing liquid should be less than or equal to 0.1MPa , the range of capacity is $0.63\text{m}^3/\text{h}$, little capacity will affect seal's life.

前应先关闭出口阀门，防止反转。

(八)、不允许用吸入管路的阀门来调节流量，以免发生汽蚀。

(九)、根据输送介质黏度不同，机械密封在轴径大于 $\Phi 50\text{mm}$ 时其允许有 $\leq 5\text{mL/h}$ 的泄漏，轴径小于 $\Phi 50\text{mm}$ 时其允许有 $\leq 3\text{mL/h}$ 的泄漏。

(十)、应经常检查冷却冲洗液的流动情况，如一旦发现断冷却冲洗液时，不要马上加水，应停机待机械密封冷却后再加水，以免机械密封受热胀冷缩而损坏，冷却冲洗液的温升在 20°C 以内是正常的。

(十一)、泵不应当在小于泵设计流量 $1/3$ 时长期运转。如果必须在该条件下连续运转，则应在泵的出口安装旁通管，使泵的流量达到规定的使用范围。

(十二)、当系统需长时间停车时，应对泵全面的清洗，清除残留的腐蚀液，防止结晶。

6. Before startup, first switch on the cooling liquid, when stopping operation, first stop the pump, and then switch off the cooling liquid.

7. Before startup, make sure that rotating direction is correct. Shall close the outlet valve to protect reverse turning prior to turning off the pump.

8. Adjusting flow with the valve of suction pipeline is not permitted.

9. Depending on different viscosities of the media, the leakage allowance is $\leq 5\text{mL/h}$ for the mechanical seal when the shaft diameter is greater than $\Phi 50\text{mm}$; the same is $\leq 3\text{mL/h}$ for the mechanical seal when the shaft diameter is smaller than $\Phi 50\text{mm}$.

10. Often check the condition of the cooling liquid. If the flushing liquid interrupted, do not dose water immediately, but do this after the mechanical seal is cooled in case it is damaged due to the sudden cooling or heating. The rising of the temperature of the cooling liquid within 20°C is normal.

11. Pump should not operate with the capacity below one third of the pump's designed capacity for a long term. If it must operate continuously under this condition, a bypass pipe should be installed at the discharge of the pump to make the pump run in the operating scope stimulated.

12. When the system needs to stop operation for a long term, the pump should be washed overall, the residual corrosive liquid should be cleaned up to prevent crystallization.

六、订货须知 NOTICE TO ORDER

(一) 配用电机的额定输出功率与泵的额定轴功率之比应按照下列规定：

泵的轴功率	百分比%
18.5kW以下	125%
(22~75) kW	115%
75kW以上	110%

1. The ratio of the motor's rated power to the pump's shaft power should be the following:

The shaft power of the pump	the ratio (%)
Below 18.5kW	125%
(22-75)kW	115%
Above 75kW	110%

(二) 压滤机前置泵尽可能选用低转速泵。

2. For filter pre-pumps, choose low-speed ones as far as possible.

(三) 订货时按《泵工作条件》详细填写。

3. When ordering, please fill in the table "Working conditions of the pump".

(四) 保修条款只有在使用本公司原厂备件时才有法律效力。

4. Warranty is valid only when genuine spare parts of our company are used.

七、技术参数 PERFORMANCE TABLE OF MHT SERIES PUMP

基本参数 Basic Parameter 型号 Pump model	转速 r/min Speed	流量 m ³ /h Capacity Range	扬程 m Head Range	额定 流量 m ³ /h Capacity	额定 扬程 m Total head	效率 % Efficiency	轴功率 kW Shaft power	配套电机 Matched motor	
								比重 $\gamma=1.00$	比重 $\gamma=1.35$
65-40-200	1450	10~15	10~15	12.5	12.5	33.8	1.26	Y100L1-4/2.2	Y100L2-4/3
65-40-315	1450	10~15	24~34	12.5	32	33	3.30	Y112M-4/4	Y132S-4/5.5
65-40-400	1450	20~38	45~56	32	50	37.7	11.55	Y160L-4/15	Y180M-4/18.5
	980	13.5~25.6	20~25	21.5	23	34.3	3.92	Y160M-6/7.5	Y160L-6/11
65-40-550	980	10~35	50~55	25	55	21.8	17	Y200L2-6/22	Y225M-6/30
	750	7.5~26	28.5~32	19	32	19.5	10.08	Y200L-8/15	Y225S-8/18.5
80-50-200	1450	20~38	10~15	32	12.5	50	2.18	Y100L2-4/3	Y112M-4/4
80-50-250	1450	20~38	18~23	32	20	50	3.48	Y132S-4/5.5	Y132M-4/7.5
80-50-315	1450	22~40	24~34	35	32	40.8	7.47	Y160M-4/11	Y160L-4/15
80-65-400	1450	45~80	42~60	70	55	50	20.96	Y200L-4/30	Y225S-4/37
	980	34~54	19~27	47	25	45	7.11	Y160L-6/11	Y180L-6/15
100-65-200	1450	40~60	10~15	50	12.5	51.6	3.30	Y132S-4/5.5	Y132M-4/7.5
100-65-250	1450	40~60	16~22	50	20	50.1	5.43	Y132M-4/7.5	Y160M-4/11
100-65-270	1450	45~80	20~27	70	25	52.4	9.09	Y160L-4/15	Y180M-4/18.5
100-65-315	1450	56~84	24~34	75	32	49.3	13.25	Y160L-4/15	Y180M-4/18.5
	980	37.8~56.7	11~16	50	14.5	46.8	4.22	Y160M-6/7.5	Y160L-6/11
100-65-450	1450	64~96	54~75	80	70	48	31.76	Y225S-4/37	Y250M-4/55
	980	43~65	24.5~34	54	32	42.2	11.15	Y200L1-6/18.5	Y200L2-6/22
100-65-500	1450	72~120	65~90	100	85	47	49.23	Y250M-4/55	Y280S-4/75
	980	48~81	29~41	67	38	43.3	16.01	Y200L2-6/22	Y225M-6/30
125-100-200	1450	80~120	8~14	100	12.5	56.7	6.00	Y160M-4/11	Y160L-4/15
125-100-280	1450	80~120	20~27	100	25	56.7	12.00	Y160L-4/15	Y180M-4/18.5
125-100-315	1450	80~120	25~35	100	32	62	14.05	Y180M-4/18.5	Y180L-4/22

基本参数 Basic Parameter 型号 Pump model	转速 r/min Speed	流量 m ³ /h Capacity Range	扬程 m Head Range	额定 流量 m ³ /h Capacity	额定 扬程 m Total head	效率 % Efficiency	轴功率 kW Shaft power	配套电机 Matched motor	
								比重 $\gamma=1.00$	比重 $\gamma=1.35$
125-100-400	1450	80~130	45~56	110	50	60	24.95	Y225S-4/37	Y250M-4/55
	980	54~87	20~25	75	23	52	9.03	Y160L-6/11	Y180L-6/15
125-100-450	1450	80~130	50~75	110	70	60	34.94	Y225M-4/45	Y250M-4/55
	980	54~88	22~34	75	32	53	12.33	Y180L-6/15	Y200L1-6/18.5
125-100-500	1450	90~160	60~85	120	80	48.2	54.22	Y280S-4/75	Y280S-4/75
	980	60~108	27~38	81	36	45	17.64	Y225M-6/30	Y225M-6/30
125-100-550	980	80~120	45~54	100	50	56	24.31	Y250M-6/37	Y280S-6/45
	750	60~90	25.6~31	75	28.5	52	11.19	Y225S-8/18.5	Y225M-8/22
125-100-600	980	54~88	50~68	75	66	40.6	33.19	Y280M-6/55	Y315S-6/75
	750	41~66	28.5~39	56	38	38.8	14.93	Y250M-8/30	Y280S-8/37
150-125-315	1450	160~350	25~35	250	32	63.2	34.46	Y225M-4/45	Y250M-4/55
	980	108~200	10~15.5	150	14.5	59.1	10.02	Y180L-6/15	Y200L1-6/18.5
150-125-400	1450	160~240	45~56	200	50	60.4	45.07	Y250M-4/55	Y280S-4/75
	980	108~162	20.5~25.5	135	23	56.9	14.86	Y200L1-6/18.5	Y200L2-6/22
150-125-450	1450	160~240	50~68	200	66	70	51.33	Y280S-4/75	Y280S-4/75
	980	108~162	22.8~31	135	30	61	18.07	Y200L2-6/22	Y225M-6/30
150-125-500	980	140~210	27~38	170	35	60	27.00	Y250M-6/37	Y280S-6/45
	750	106~158	15~21.5	128	20	53.2	13.10	Y200L-8/15	Y225S-8/18.5
150-125-550	980	140~210	45~56	170	50	62	37.32	Y280S-6/45	Y280M-6/55
	750	106~158	25.6~32	128	28.5	58	17.12	Y225M-8/22	Y250M-8/30
150-125-600	980	160~240	50~68	200	66	58	61.95	Y315S-6/75	Y315M-6/90
	750	122~183.5	28.5~39	153	38	55	28.78	Y280S-8/37	Y280M-8/45
200-150-320	1450	240~360	22~35	300	32	70	37.33	Y225M-4/45	Y250M-4/55
	980	160~240	10~15.5	200	14.5	65	12.15	Y200L1-6/18.5	Y200L2-6/22

基本参数 Basic Parameter 型号 Pump model	转速 r/min Speed	流量 m ³ /h Capacity Range	扬程 m Head Range	额定 流量 m ³ /h Capacity	额定 扬程 m Total head	效率 % Efficiency	轴功率 kW Shaft power	配 套 电 机 Matched motor	
								比重 $\gamma=1.00$	比重 $\gamma=1.35$
200-150-540	980	180~260	45~52	220	50	65	46.07	Y280M-6/55	Y315S-6/75
	750	135~196	25.5~30	166	28.5	63	20.44	Y250M-8/30	Y280S-8/37
200-150-590	980	216~324	50~68	270	66	62	78.24	Y315M-6/90	Y315L ₁ -6/110
	750	165~246	28.5~39	206	38	60	35.52	Y280M-8/45	Y315S-8/55
200-150-315	1450	360~480	20~33	400	32	70	49.78	Y250M-4/55	Y280S-4/75
	980	216~324	9~15	270	14.5	65	16.40	Y200L ₂ -6/22	Y225M-6/30
200-150-400	980	216~324	20.5~23.5	270	23	65	26.01	Y250M-6/37	Y280S-6/45
	750	166~260	12~15	208	13.5	61.9	12.35	Y225S-8/18.5	Y225M-8/22
200-150-500	980	280~435	30~37	360	35	68	50.44	Y315S-6/75	Y315M-6/90
	750	210~330	17~23	272	20	65	22.78	Y250M-8/30	Y280S-8/37
200-150-600	980	360~480	48~58	400	55	68	88.07	Y315L ₁ -6/110	Y315L ₂ -6/132
	750	271~362	27~33	302	31	65	39.21	Y280M-8/45	Y315S-8/55
200-150-650	980	360~480	50~68	400	66	70	102.67	Y315L ₂ -6/132	Y355M ₁ -6/160
	750	271~362	28.5~39	302	38	68	45.94	Y315S-8/55	Y315M-8/75
250-200-450	980	480~720	22~28	600	25	76	53.73	Y315S-6/75	Y315S-6/75
	750	367~544	12~16	460	14	73	24.02	Y250M-8/30	Y280S-8/37
250-200-500	980	480~720	30~37	600	36	75	78.40	Y315M-6/90	Y315L ₁ -6/110
	750	367~544	17~23	460	21.5	72	37.39	Y280M-8/45	Y315S-8/55
250-200-550	980	480~720	45~52	600	50	72	113.43	Y315L ₂ -6/132	Y355M ₁ -6/160
	750	367~544	25.5~31	460	30	68	55.25	Y315M-8/75	Y315M-8/75
250-200-650	980	480~720	50~68	600	66	70	154.00	Y355M ₁ -6/160	Y355M ₂ -6/220
	750	367~544	28.5~39	460	38	66	72.10	Y315L ₁ -8/90	Y315L ₂ -8/110

主要产品系列

ÍJ 化工流程泵
AZ 浆泵
HLT 立式化工通道泵
HJD 化工多级泵
HPA/HPB 石油化工流程泵
HZW 轴流泵
ÍFK 氟塑料泵
HY 化工液下泵
MHT 轻型渣浆泵
HZJ 重型渣浆泵
HYM 液下渣浆泵
FGD 石灰石石膏脱硫泵
HBE 液环真空泵
HW 化工混流泵
MSD 中开多级泵
HYD 液下多级泵
HRV 高温熔盐泵
ÍP 石化流程泵
HBR 工业软管泵

MAIN PRODUCT SERIES

ÍJ Chemical process pump
AZ Pulp pump
HLT Vertical chemical process pump
HJD Chemical multi-stage pump
HPA/HPB Petrochemical process pump
HZW Axial-flow pump
ÍFK Plastic pump
HY Chemical submerged pump
MHT Light-duty slurry pump
HZJ Heavy-duty slurry pump
HYM Submerged slurry pump
FGD Pump for flue gas desulfurization
HBE Liquid ring vacuum pump
HW Chemical mixed-flow pump
MSD Split multistage pump
HYD Submerged multistage pump
HRV High temperature liquid salts pump
ÍP Petrochemical process pump
HBR Industry hose pump

杭州市三墩镇西湖科技园西园五路12号 邮编Zip: 310030
No.12 Xiyuan 5 Road, Westlake Science & Technology
Zone, Sandun Town, Hangzhou
[Http://www.hbgroups.com](http://www.hbgroups.com)

销售部电话Tel:+86 571 89905601 89905603
+86 571 89900102(For International Clients)
销售部传真Fax:+86 571 89905602
E-mail:sales@hbgroups.com